

# Hartwood 10 Mile V 2012

Hartwood, Virginia  
Measured by Vic Culp  
On July 15, 2012

Stoney Hill



USATF - CERTIFIED  
COURSE  
VA12034RT  
IN EFFECT  
7/15/2012 - 12/31/2022

Hartwood

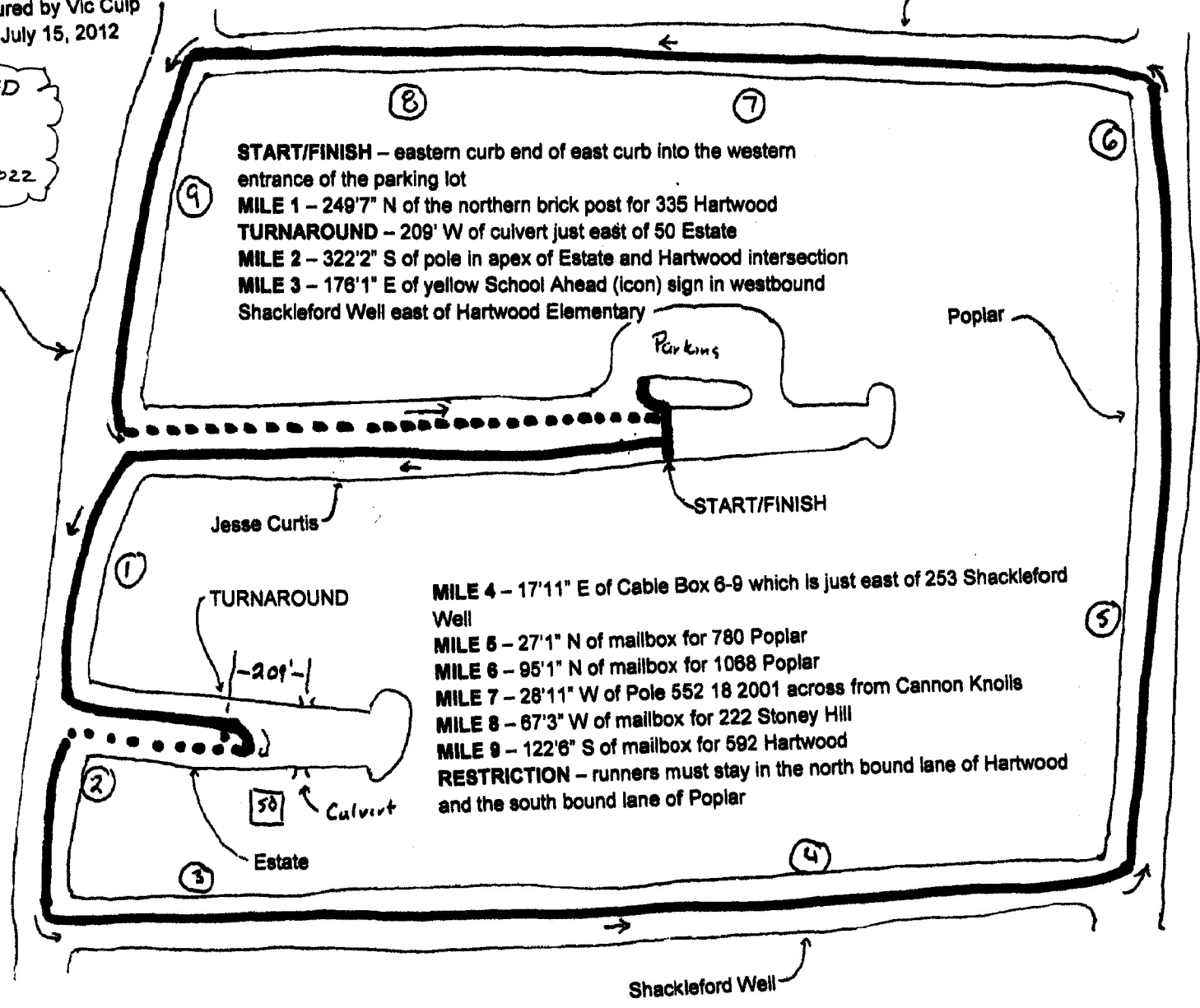

**START/FINISH** - eastern curb end of east curb into the western entrance of the parking lot

**MILE 1** - 249'7" N of the northern brick post for 335 Hartwood

**TURNAROUND** - 209' W of culvert just east of 50 Estate

**MILE 2** - 322'2" S of pole in apex of Estate and Hartwood intersection

**MILE 3** - 176'1" E of yellow School Ahead (icon) sign in westbound Shackleford Well east of Hartwood Elementary

Jesse Curtis

TURNAROUND

50  
Culvert

Estate

Parking

Poplar

START/FINISH

**MILE 4** - 17'11" E of Cable Box 6-9 which is just east of 253 Shackleford Well

**MILE 5** - 27'1" N of mailbox for 780 Poplar

**MILE 6** - 95'1" N of mailbox for 1088 Poplar

**MILE 7** - 28'11" W of Pole 552 18 2001 across from Cannon Knolls

**MILE 8** - 67'3" W of mailbox for 222 Stoney Hill

**MILE 9** - 122'6" S of mailbox for 592 Hartwood

**RESTRICTION** - runners must stay in the north bound lane of Hartwood and the south bound lane of Poplar

Shackleford Well